

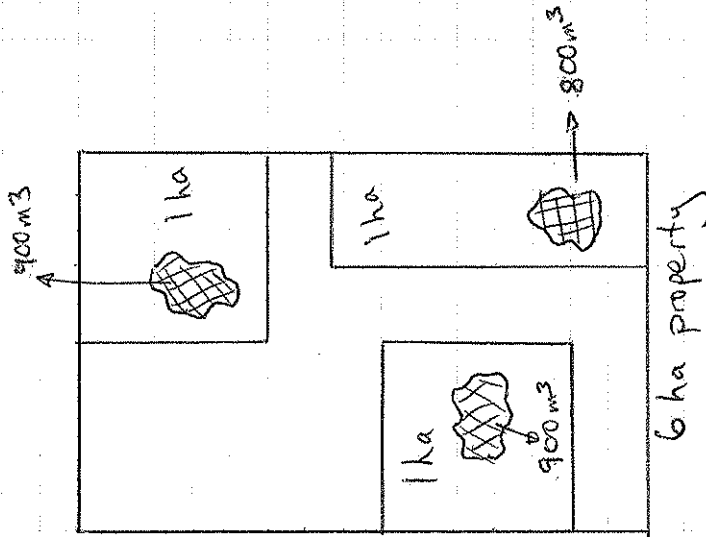

Scenario One:



Permitted land disturbance as each disturbance is no greater than 1000m³ and is within a 10,000m² area.

Scenario Two:

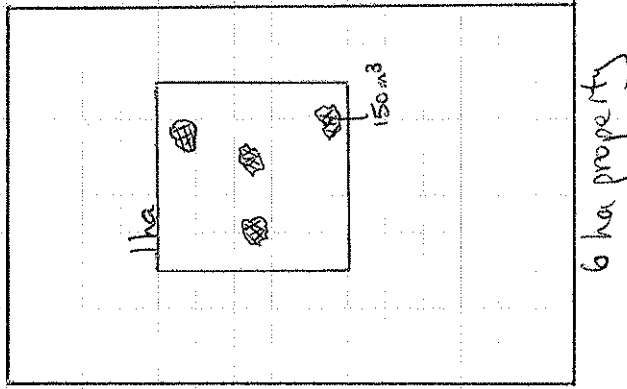

Permitted land disturbance as a total of less than 1000m³ of land disturbance occurs within a 10,000m² area.

Scenario Three:

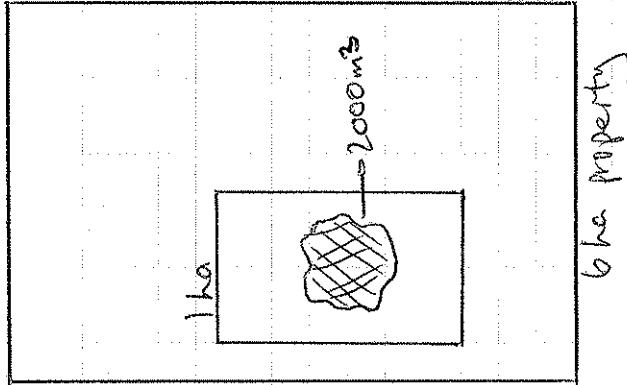

Not permitted land disturbance as more than 1000m³ occurs within a 10,000m² area.

Examples of application of Rule 2 of Wellington Regional Soil Plan (quoted at para 5.4 of Emily Suzanne Grace's evidence)

Scale
H 20m

Prepared by Emily Grace 18/7/08