

Schedule G: Airsheds

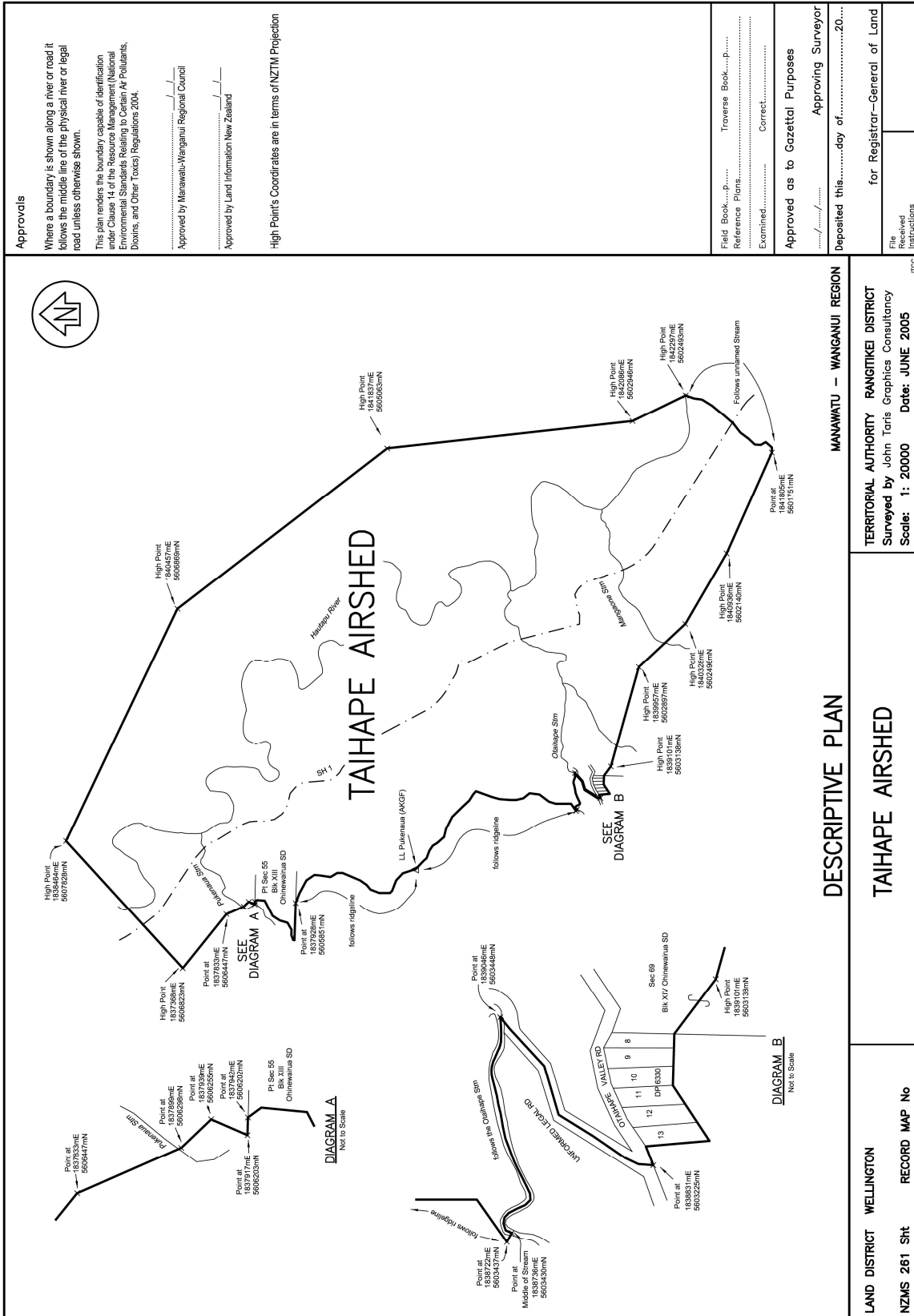

Map Figure G:1 Taihape Airshed

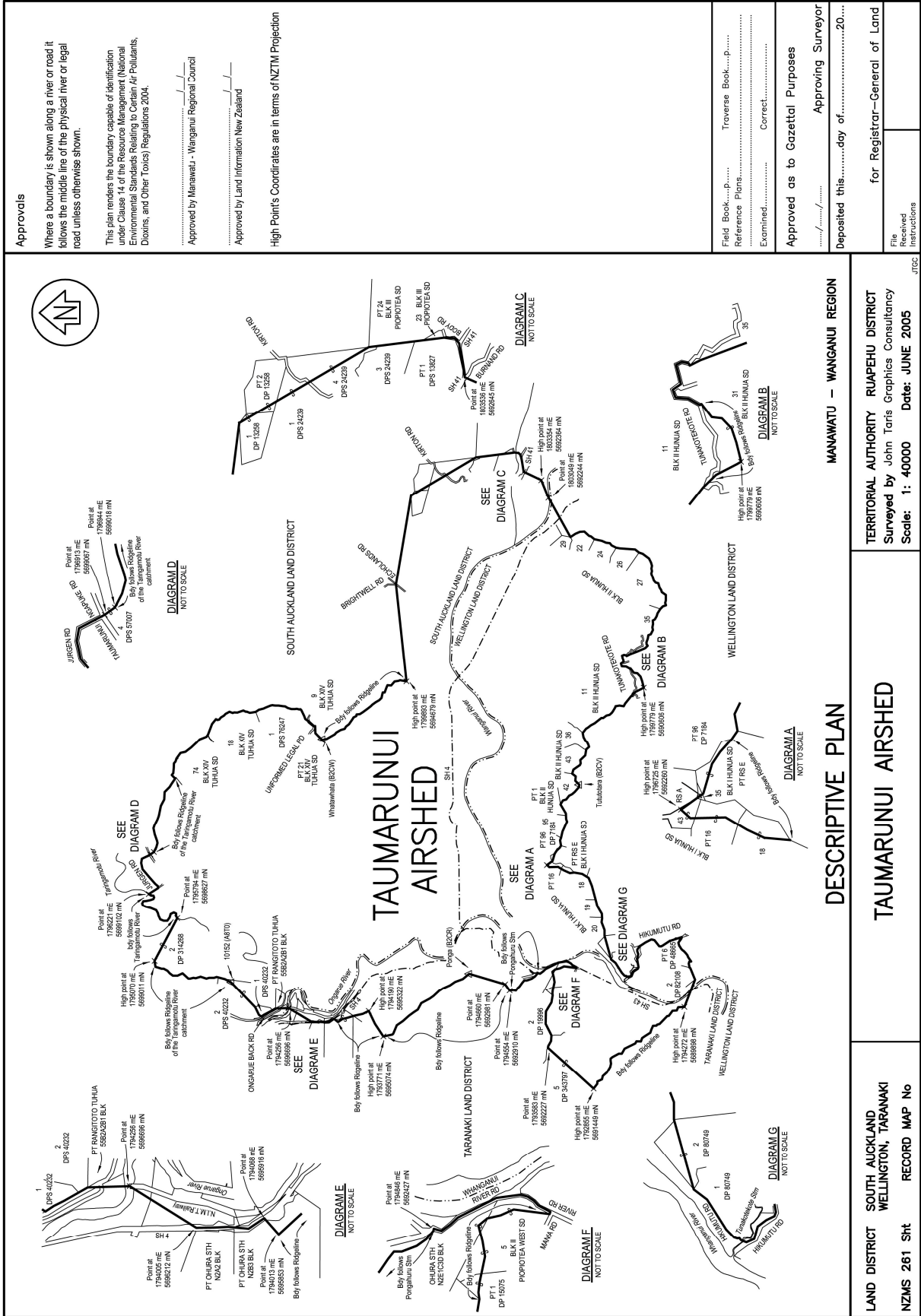

Approvals

Where a boundary is shown along a river or road it follows the middle line of the physical river or legal road unless otherwise shown.

This plan renders the boundary capable of identification under Clause 14 of the Resource Management (National Environmental Standards Relating to Certain Air Pollutants, Dioxins, and Other Toxins) Regulations 2004.

Approved by Manawatu - Wanganui Regional Council

Approved by Land Information New Zealand

High Point's Coordinates are in terms of NZTM Projection

Field Book...P..... Traverse Book...P.....
 Reference Plans.....
 Examined..... Correct.....

Approved as to Gazetted Purposes
 /...../..... Approving Surveyor

Deposited this.....day of.....20.....

for Registrar-General of Land
 File Received Instructions

MANAWATU - WANGANUI REGION

DESCRIPTIVE PLAN

TAUMARUNUI AIRSHED

TERRITORIAL AUTHORITY RUAPEHU DISTRICT
 Surveyed by John Tarrs Graphics Consultancy
 Scale: 1: 40000 Date: JUNE 2005

LAND DISTRICT SOUTH AUCKLAND
 WELLINGTON, TARANAKI
 NZMS 261 Sht RECORD MAP No

JTC

Map Figure G.2 Taumarunui Airshed