

Appendix A Titles and Gazette Notice

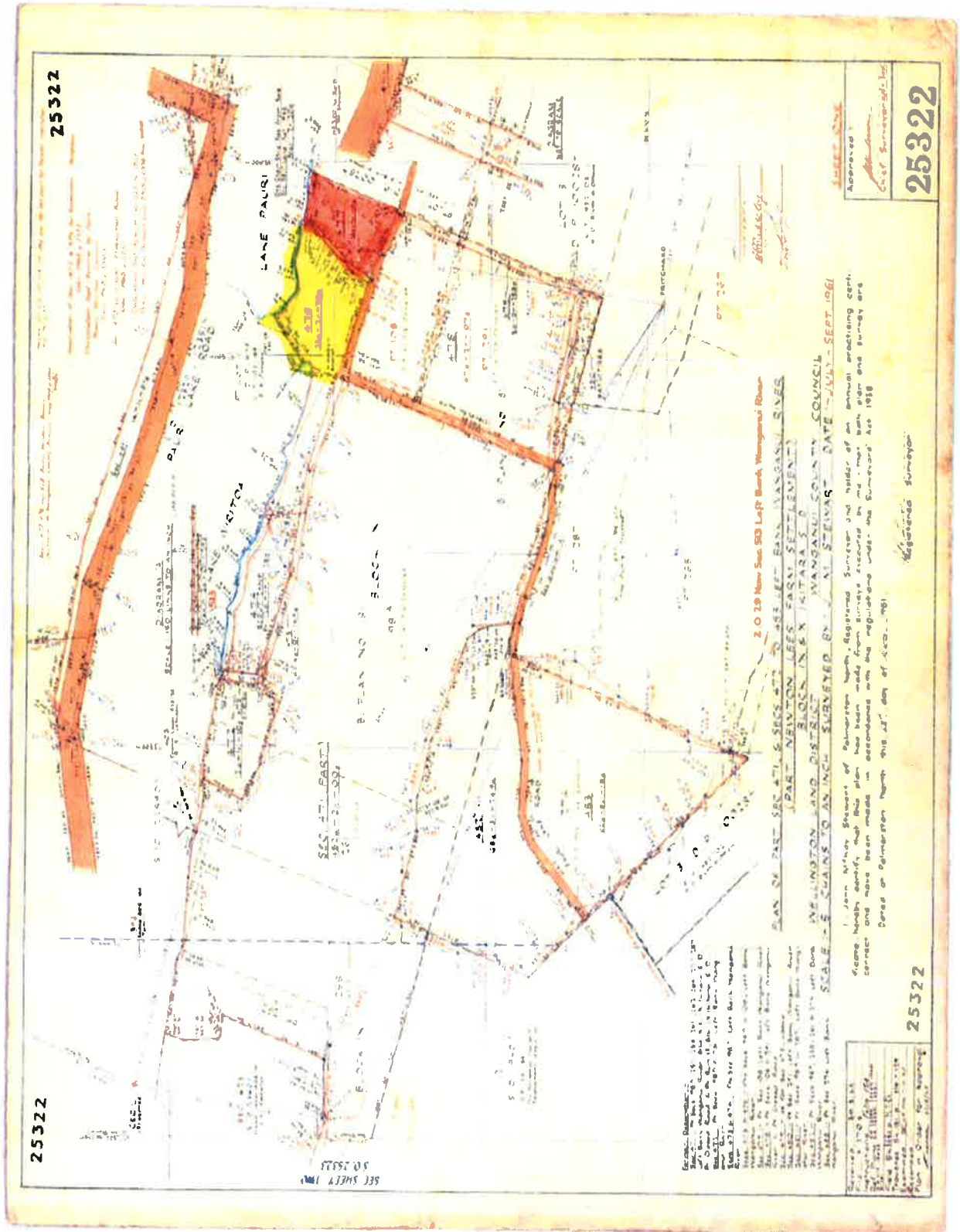

1

1800

GN 646341 Gazette Notic

Copy 01/01 Pgs - 002,27/11/12,08,10



Doc# 611440015

Extract from *N.Z. Gazette*, 9 Sept. 1965, No. 50, page 1513

Reservation of Land

PURSUANT to the Land Act 1948, the Minister of Lands hereby sets apart the land described in the Schedule hereto as a reserve for recreation purposes.

SCHEDULE

WELLINGTON LAND DISTRICT—WANGANUI COUNTY
SECTIONS 472 and 476, Left Bank Wanganui River, situated in Block X, Hikitara Survey District: Area, 36 acres and 8 perches, more or less (S.O. Plan 25322).

Dated at Wellington this 3rd day of September 1965.

R. G. OBRARD, Minister of Lands.

(L. and S. H.O. 1/1574; D.O. 8/3/171)

R. E. OWEN, Government Printer, Wellington, New Zealand.

1.

646341

57

Particulars of Entries in Register-book.

Vol. No. 632901 - Index.

28 SEP 1965

11.15



Gazette notice 646342 declaring the
within reserve to be a public domain
subject to the provisions of Part III of
the Reserves and Domains Act 1953
to be known as the ~~Paari~~ Whirton
Domain and appointing the Whanganui
City Council to be the Domain Board
28.9.1965 at 11.15am

J. Keenan

~~NEO 72165~~ ^{as follows} ~~as follows~~

Entered ~~ET 50/154 issued for Lot 61 plan 1374~~
in error ~~ET 50/160 issued for Lot 1 plan 7665~~

No. 632901

(1)

Recorded on Land Register
10. 4/1/60



THE NEW ZEALAND GAZETTE No. 68

1572

Classification of Reserves

PURSUANT to the Reserves Act 1977, and to a delegation from the Minister of Lands, the Assistant Commissioner of Crown Lands hereby declares the reserves, described in the Schedule hereto, to be classified as reserves for the purposes specified at the end of the respective descriptions of the said lands, subject to the provisions of the said Act.

SCHEDULE

WELLINGTON LAND DISTRICT—PORIRUA CITY

8645 square metres, more or less, being Lot 232, D.P. 31478, situated in Block II, Belmont Survey District. All *Gazette* notice 053345.1, recreation purposes.

146 square metres, more or less, being Lot 13, D.P. 32847, situated in Block II, Belmont Survey District. All *Gazette* notice 054294.1, local purpose (utility).

3994 square metres, more or less, being Lots 6, 7 and 8, D.P. 33985, situated in Block II, Belmont Survey District. All *Gazette* notice 093379, local purpose (plantation).

32,829 hectares, more or less, being part Lot 1, D.P. 28193, situated in Block II, Belmont Survey District. All certificate of title 10A/706. Subject to the building line restrictions imposed by K 423809 and K 451093, recreation purposes.

3867 square metres, more or less, being Lot 3, D.P. 29997, situated in Block II, Belmont Survey District. All *Gazette* notice 804088, recreation purposes.

Dated at Wellington this 13th day of May 1981.

F. G. J. MUIRHEAD,
Assistant Commissioner of Crown Lands
(L. and S. H.O. Res. 7/9/5, Res. 7/2/135; D.O. 8/5/294)

Classification of Reserve

PURSUANT to the Reserves Act 1977, and to a delegation from the Minister of Lands, the Assistant Commissioner of Crown Lands hereby declares the reserve, described in the Schedule hereto, to be classified as a reserve for scenic purposes, subject to the provisions of section 19 (1) (a) of the said Act.

SCHEDULE

WELLINGTON LAND DISTRICT—FEATHERSTON COUNTY

1,6919 hectares, more or less, being Lot 1, D.P. 49734, situated in Block XIV, Wairarapa Survey District. All certificate of title 20D/964. Subject to right of way easement created by T. 3798104.

Dated at Wellington this 9th day of May 1981.

F. G. J. MUIRHEAD,
Assistant Commissioner of Crown Lands
(L. and S. H.O. Res. 7/3/173; D.O. 13/306)

Classification of a Reserve

PURSUANT to the Reserves Act 1977, and to a delegation from the Minister of Lands, the Assistant Commissioner of Crown Lands hereby declares the reserve, described in the Schedule hereto, to be classified as a reserve for recreation purposes, subject to the provisions of the said Act.

SCHEDULE

WELLINGTON LAND DISTRICT—PORIRUA CITY

3,1009 hectares, more or less, being Lot 126, D.P. 28248, situated in Block II, Belmont Survey District. All *Gazette* notice 375270.1.

Dated at Wellington this 13th day of May 1981.

F. G. J. MUIRHEAD,
Assistant Commissioner of Crown Lands
(L. and S. H.O. Res. 7/2/309; D.O. 8/5/294)

Classification of Reserve

PURSUANT to the Reserves Act 1977, and to a delegation from the Minister of Lands, the Assistant Commissioner of Crown Lands hereby declares the reserve, described in the Schedule hereto, to be classified as a reserve for recreation purposes, subject to the provisions of the said Act.

SCHEDULE

WELLINGTON LAND DISTRICT—WANGANUI COUNTY—
WANGANUI COUNTY DOMAIN RECREATION RESERVE

2,2611 hectares, more or less, being Section 26, Kohanga Village, situated in Block X, Mangawhero Survey District. Part *Gazette* notice 764680, S.O. Plan 14919.

15,4715 hectares, more or less, being Sections 472, 476, and 513, left bank Wanganui River, situated in Block X, Teitiana Survey District. Balance *Gazette* notice 764680, S.O. Plan 25322.

Dated at Wellington this 9th day of May 1981.

F. G. J. MUIRHEAD,
Assistant Commissioner of Crown Lands
(L. and S. H.O. Res. 7/2/188; D.O. 8/3/171)

Reservation of Land

PURSUANT to the Land Act 1948, and to a delegation from the Minister of Lands, the Assistant Commissioner of Crown Lands hereby sets apart the land, described in the Schedule hereto, as a reserve for recreation purposes.

SCHEDULE

MARLBOROUGH LAND DISTRICT—BLENHEIM BOROUGH

5080 square metres, more or less, Lot 35, D.P. 5583, situated in Block XVI, Cloudy Bay Survey District. All certificate of title 3D/463.

Dated at Blenheim this 14th day of May 1981.

D. I. MURPHY,
Assistant Commissioner of Crown Lands
(L. and S. H.O. Res. 8/2/37; D.O. 4/3)